

LOW FORWARD VOLTAGE SCHOTTKY BARRIER DIODES

Features

- ◆ V@Á |æ cÁæ æ æ ^Áæ |á •ÁV| á! , |æ! •Áæ |æ | Áæ { æææ Á |æ •æææ } ÁI XÉÁU[PÜÉ{ } |æ c
- ◆ QáæÁ |Á |á c áÁæ & áÁæ |æ æá
- ◆ U] ^} ÁR } &á } Áæ Á
- ◆ Š | , Áæ! •Áæ æ æ Pá @Á | , æáÁ ~! * ^Áæ | | ^} á
- ◆ &æ æææ Pá @Á { } |æ | Áæ |á!á * Á ~ ææ c ^á
- ◆ G € Áæ ^Áæ |á •Áæ |á |á æ Á

Mechanical Data

Case: UT Ø molded plastic body

Terminals: Solderable per MIL-STD-750, Method 2026A

Polarity: Polarity symbol marking on body

Mounting Position: Any

Weight : 0.00€J ounce, 0.0G7 grams

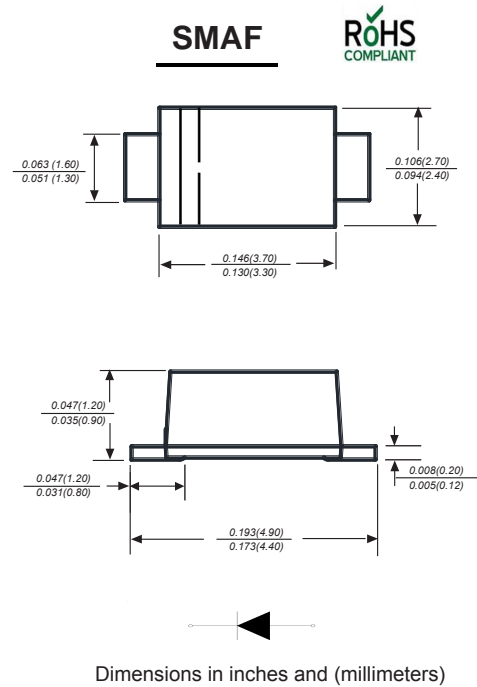

Maximum Ratings And Electrical Characteristics

Ratings at 25°C ambient temperature unless otherwise specified.

Single phase half-wave 60Hz, resistive or inductive load, for capacitive load current derate by 20%.

Parameter	SYMBOLS	SL56F	UNITS
Marking Code		MDD SL56F	
Maximum repetitive peak reverse voltage	V_{RRM}	60	V
Maximum RMS voltage	V_{RMS}	42	V
Maximum DC blocking voltage	V_{DC}	60	V
Maximum average forward rectified current	$I_{(AV)}$	5.0	A
Peak forward surge current 8.3ms single half sine-wave superimposed on rated load (JEDEC Method)	I_{FSM}	150	A
Maximum instantaneous forward voltage at 5.0A	V_F	0.5	V
Maximum DC reverse current $T_A=25^\circ\text{C}$ at rated DC blocking voltage $T_A=100^\circ\text{C}$	I_R	1.0 50	mA
Typical junction capacitance (NOTE 1)	C_J	500	pF
Typical thermal resistance (NOTE 2)	$R_{\theta JA}$	45	$^\circ\text{C}/\text{W}$
Operating junction temperature range	T_J	-55 to +150	$^\circ\text{C}$
Storage temperature range	T_{STG}	-55 to +150	$^\circ\text{C}$

- Note:**
1. Measured at 1.0MHz and applied reverse voltage of 4.0V D.C.
 2. P.C.B. mounted with 2.0x2.0"(5.0x5.0cm) copper pad areas
 3. The typical data above is for reference only.

Typical Characteristics

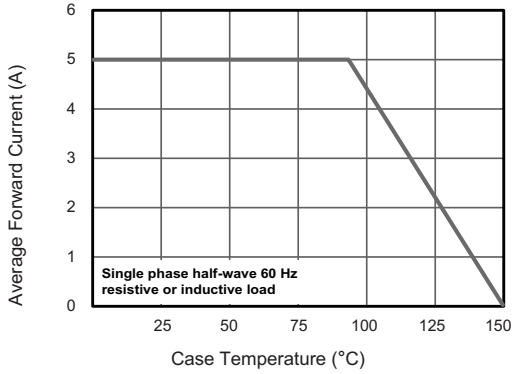
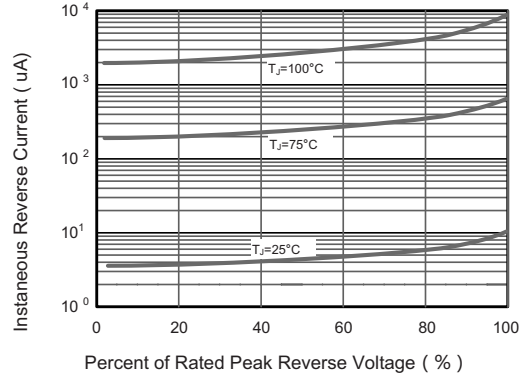
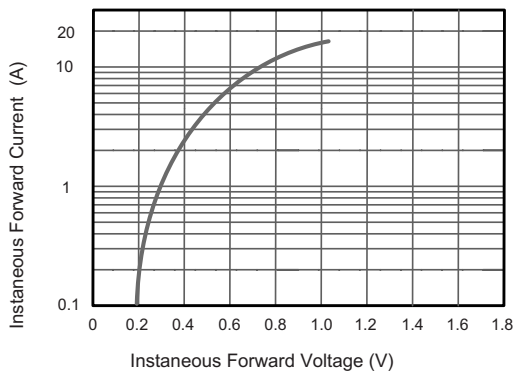
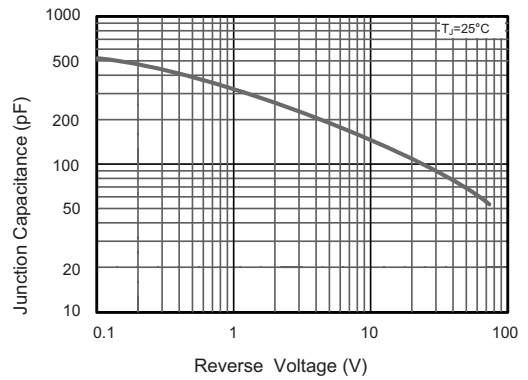
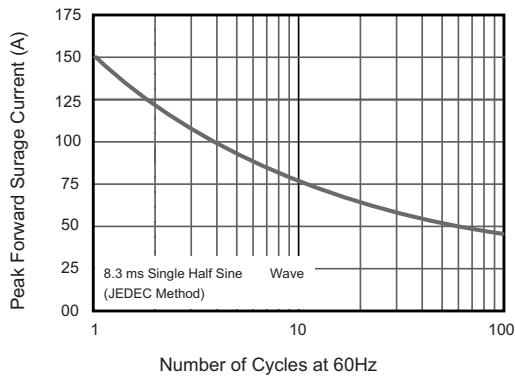
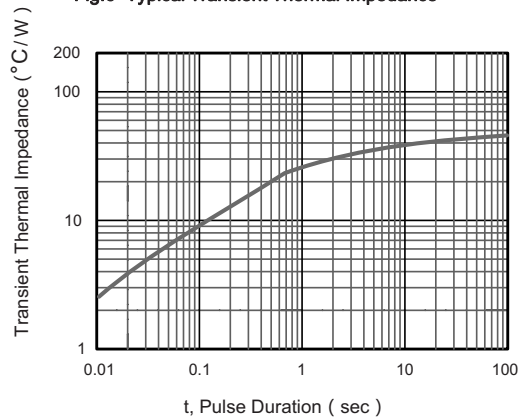
Fig.1 Forward Current Derating Curve

Fig.2 Typical Reverse Characteristics

Fig.3 Typical Forward Characteristic

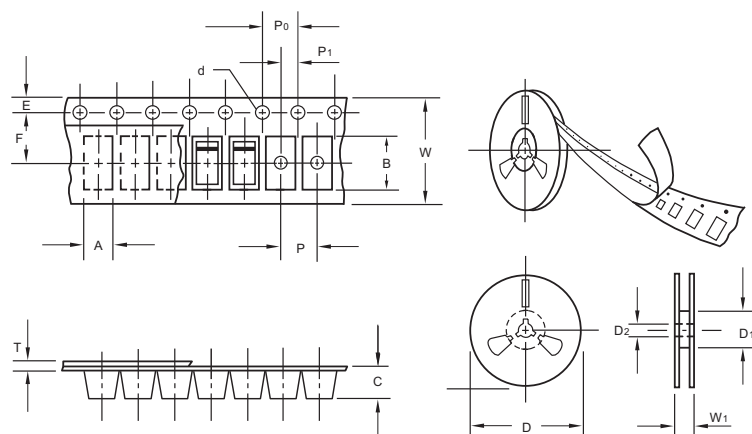
Fig.4 Typical Junction Capacitance

Fig.5 Maximum Non-Repetitive Peak Forward Surge Current

Fig.6- Typical Transient Thermal Impedance

The curve above is for reference only.

Packing information



unit:mm

Item	Symbol	Tolerance	SMAF
Carrier width	A	0.1	2.80
Carrier length	B	0.1	4.75
Carrier depth	C	0.1	1.42
Sprocket hole	d	0.05	1.50
7" Reel outside diameter	D	2.0	178.00
7" Reel inner diameter	D1	min	54.40
Feed hole diameter	D2	0.5	13.00
Sprocket hole position	E	0.1	1.75
Punch hole position	F	0.1	5.05
Punch hole pitch	P	0.1	4.00
Sprocket hole pitch	P0	0.1	4.00
Embossment center	P1	0.1	2.00
Overall tape thickness	T	0.1	0.30
Tape width	W	0.3	8.00
Reel width	W1	1.0	12.30

Note: Devices are packed in accordance with EIA standard RS-481-A and specifications listed above.

Reel packing

PACKAGE	REEL SIZE	REEL (pcs)	COMPONENT SPACING (m/m)	BOX (pcs)	INNER BOX (m/m)	REEL DIA, (m/m)	CARTON SIZE (m/m)	CARTON (pcs)	APPROX. GROSS WEIGHT (kg)
SMAF	7"	3,000	4.0	6,000	210*208*203	178	400*265*400	120,000	10.0

Suggested Pad Layout

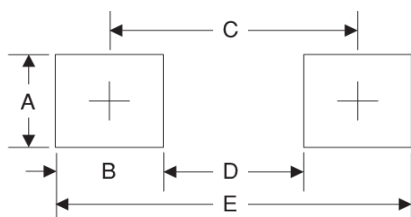

Symbol	Unit (mm)	Unit (inch)
A	1.8	0.071
B	1.6	0.063
C	3.8	0.150
D	2.2	0.087
E	5.4	0.213